



Electrolux
PROFESSIONAL

**Eco Preparation
1600 mm Storage Cabinet with
sliding doors h. 1600**

ITEM # _____

MODEL # _____

NAME # _____

SIS # _____

AIA # _____



132888 (SAS16N)

Storage Cabinet, h. 1600mm,
with 3 shelves and 2 sliding
doors, 1600mm

Short Form Specification

Item No. _____

Constructed in stainless steel. Intermediate shelves, supports and inner doors in stainless steel. Handles are formed by a fold in the sliding doors. Adjustable feet.

Main Features

- Handles in stainless steel for better hygiene and reliability.
- Sturdiness, stability and reliability of table accurately tested.

Construction

- Handles directly built into the sliding doors.
- Constructed entirely in stainless steel to offer maximum durability.
- Base panel has 40mm high profile, is 8/10 in thickness with upturned edges and bar reinforcement. It is welded to legs for further structure reinforcement.
- Two double-walled sliding doors flush fitting to the front of the frame can be removed to facilitate cleaning of the cupboard interior.
- 304 AISI stainless steel feet, 150 mm high and 54 mm in diameter, adjustable by -35/+25 mm.

Optional Accessories

- Wheel kit for cupboards, 4 wheels (2 with brakes), D=100 mm PNC 855299

APPROVAL: _____



Experience the Excellence
www.electroluxprofessional.com

Key Information:

Cabinet width:		
132888 (SAS16N)	1545 mm	
Cabinet depth:	645 mm	
Cabinet height:	1365 mm	
External dimensions, Width:	1600 mm	
External dimensions, Depth:	700 mm	
External dimensions, Height:	1600 mm	
Net weight:	123 kg	

Front

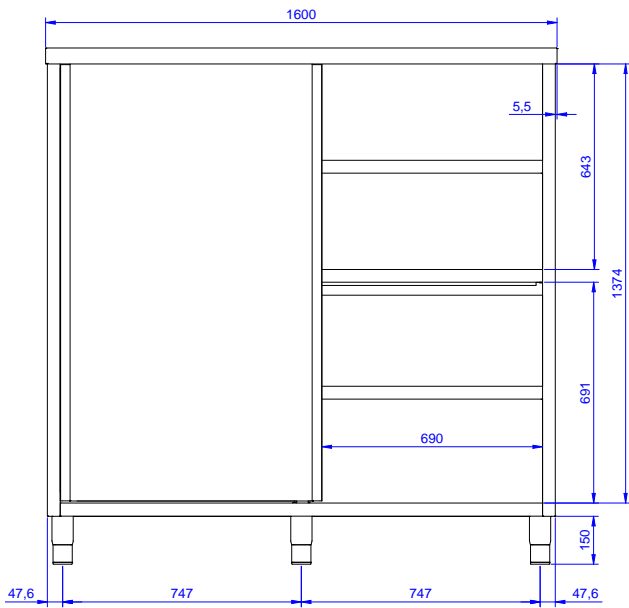

Side

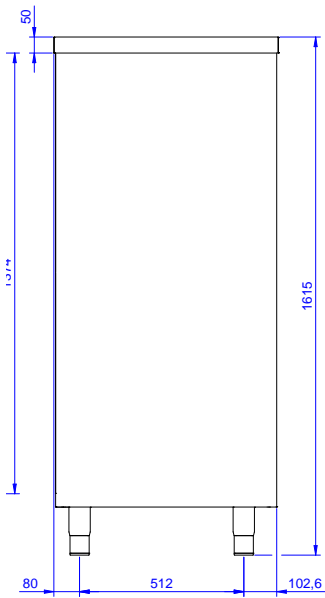

Top

